

# ozito

## AIR BRUSH KIT

6ml/min

### INSTRUCTION MANUAL

### SPECIFICATIONS

Operating Air Pressure:	15-30psi (1-2Bar)
Nozzle Size:	ø0.5mm
Spray Width:	10mm
Flow Rate:	6ml/min
Feed Type:	Suction
Paint Pot Size:	22ml
Air Inlet:	1/8" BSP

[ozito.com.au](http://ozito.com.au)

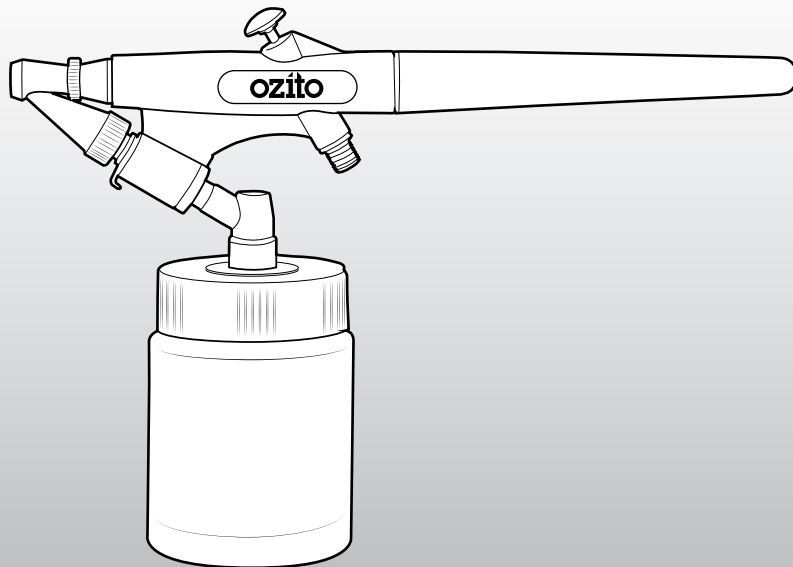

### WHAT'S IN THE BOX



Air Brush

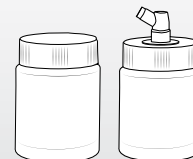

Paint Pots

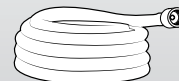

Air Hose



Connection Hood



Dropper

**3** YEAR REPLACEMENT WARRANTY

ABK-PRO

# KNOW YOUR PRODUCT

## AIRBRUSH

- |                    |                        |
|--------------------|------------------------|
| 1 Paint Outlet     | 4 Paint Regulator Dial |
| 2 Variable Trigger | 5 Paint Inlet          |
| 3 Air Inlet        | 6 Paint Pot            |

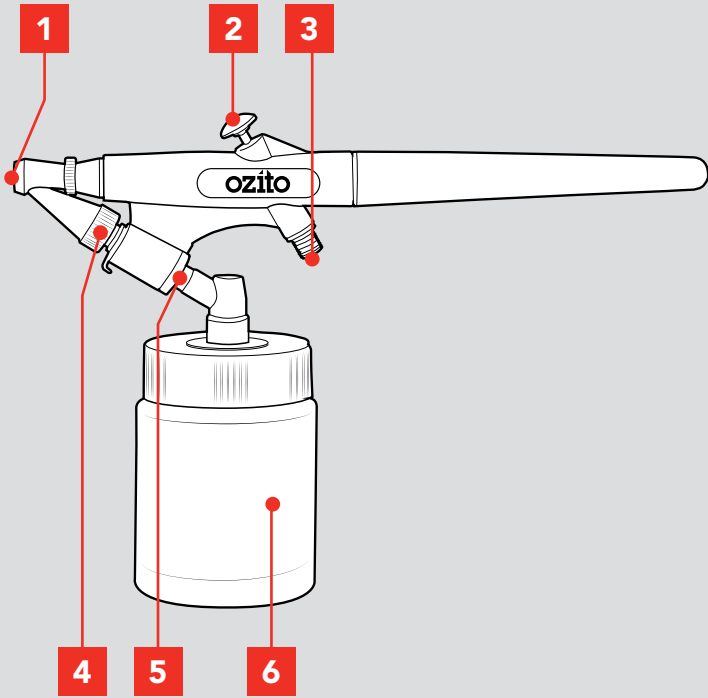

## ACCESSORIES

- |                 |                      |
|-----------------|----------------------|
| 7 Paint Pots    | 9 Connection Adaptor |
| 8 1.5m Air Hose | 10 Connection Hood   |

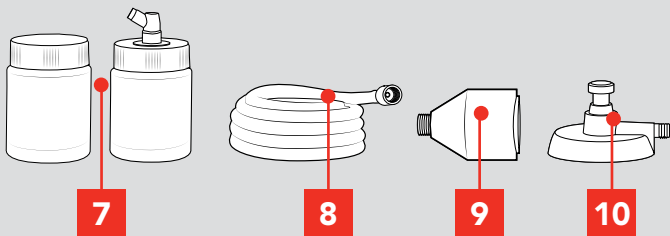

# SETUP & PREPARATION

## 1. ASSEMBLY



**WARNING!** ENSURE THE TOOL IS DISCONNECTED FROM THE AIR SUPPLY BEFORE PERFORMING ANY OF THE FOLLOWING OPERATIONS.

### Installing the Paint Pot

The kit comes with 2 paint pots, one with a standard lid for storage and one with the airbrush connection lid.

- 1 Screw the airbrush connection lid to the paint pot.
- 2 Push the outlet of the paint pot lid into the airbrush paint inlet tightly.

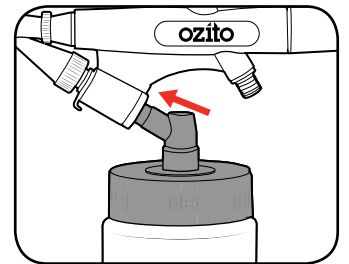
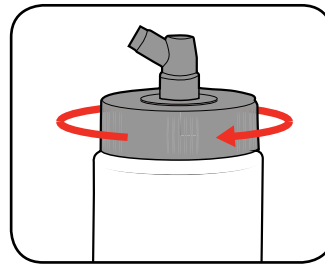

### Attaching to Air

The airbrush can be connected to either an air compressor rated at the operating pressure or a compressed air can using the connection hood.

### Attaching to a Compressed Air Can

- 1 Wrap the threaded male air inlet of the airbrush and connection hood with teflon tape in a clockwise direction.
- 2 Screw the 1/8" bsp female end of the air hose onto the airbrush and connection hood.

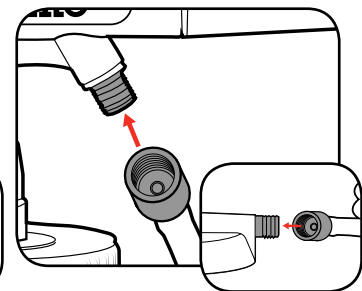
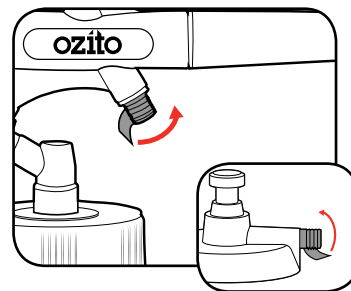

- 3 Screw the connection hood onto the compressed air can until finger tight.

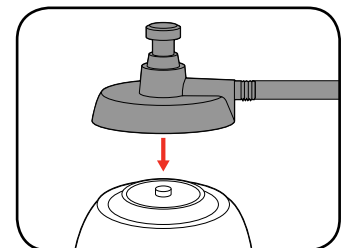

**3** YEAR REPLACEMENT WARRANTY

# OPERATION

## 2. ASSEMBLY cont.

### Attaching to an Air Compressor

To connect to an air compressor, you will need to have a 1/4" BSP male plug in your air fitting style of choice (nitto, ryco, jamec, etc.). The connection adaptor included with this kit enables you to connect 1/4" BSP fittings to the 1/8" air hose.

- 1 Wrap the threaded male air inlet of the airbrush and the connection adaptor with teflon tape in a clockwise direction.
- 2 Screw one of the air hose ends onto the male air inlet of the airbrush.

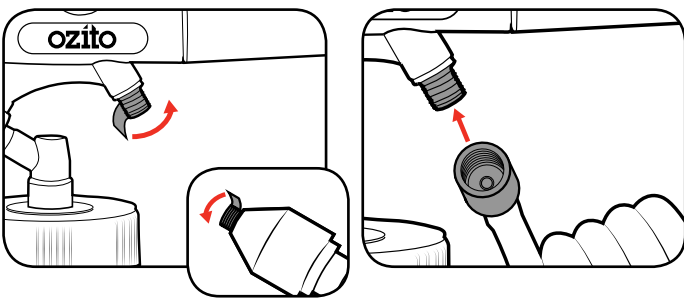

- 3 Screw the other end of the air hose onto the connection adaptor.
- 4 You can now screw a male plug air fitting into the connection adaptor.

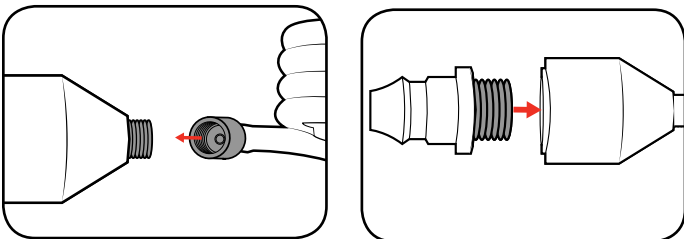

- 5 Connect to the air compressor by pull back the sleeve on air compressor hose fitting, insert the male plug & release sleeve on air compressor hose fitting.

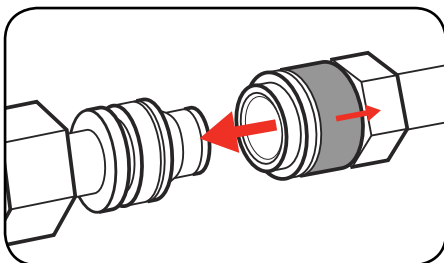

## 3. PREPARATION

**NOTE: FOR BEST RESULTS, SURFACE PREPARATION AND PAINT THINNING ARE THE TWO MOST IMPORTANT AREAS. ENSURE ALL SURFACES ARE FREE OF DUST, DIRT AND GREASE.**

### Mixing and Thinning

The airbrush kit comes with a dropper to help measure the paint and reducer mixtures to obtain the desired colour or viscosity.

**Follow the manufacturers guide for thinning and mixing ratios which should be labelled on the paint container.**

- 1 Before mixing any paint or thinners work out how much of each substance is needed.

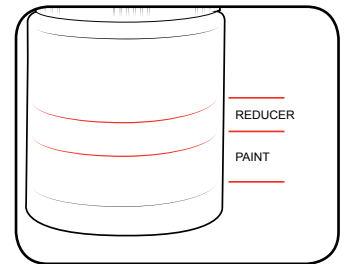

- 2 Squeeze the end of the dropper and insert into the material container. Release the pressure on the end to suck the required amount into the dropper.

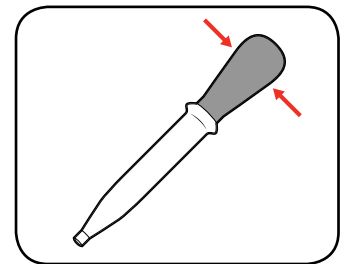

- 3 Squeeze the end of the dropper to drop the material into a mixing pot. Repeat this process for the remaining paint or reducer.

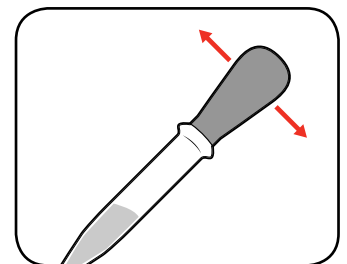

**IMPORTANT! THE AIRBRUSH CANNOT BE USED WITH MATERIALS CONTAINING ABRASIVE SUBSTANCES, GLAZES, CAUSTIC OR ALKALINE SUBSTANCES.**

### Paint Pot Vent Hole

The paint pot has a vent hole to allow air to escape which enables fluid to flow into the airbrush. Ensure it is clean and not blocked.

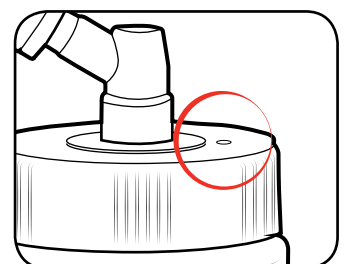

## 4. ADJUSTING THE AIRBRUSH

### Variable Trigger

- 1 Press the variable trigger to start spraying.

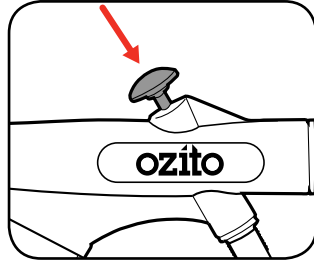

- 2 Release the variable trigger to stop spraying.

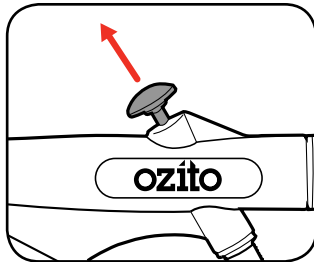

Note: The further the variable trigger is pressed, the more fluid will flow through the air brush.

### Paint Regulator Dial

The paint regulator dial is a stop that limits the amount of paint being drawn from the paint pot and can therefore limit the amount of paint being sprayed.

- 1 Fully tighten the paint regulator dial.

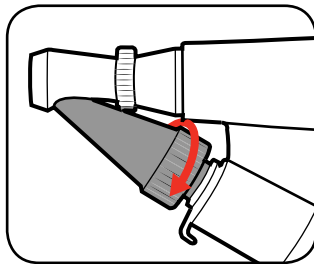

- 2 Slightly loosen the paint regulator dial, then test setting on a scrap piece of material.

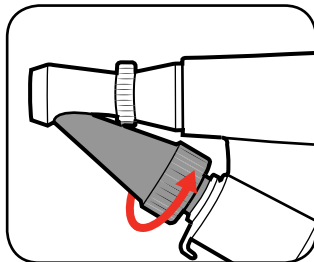

- 3 Repeat step 2 until desired fluid output is reached.

### Regulating the Air

When using the connection hood, the air can be regulated to the desired air pressure using the regulator dial on the top of the connection hood. The correct air pressure will produce an even spray pattern with little to no splatter.

- 1 Fully tighten the air regulator dial.

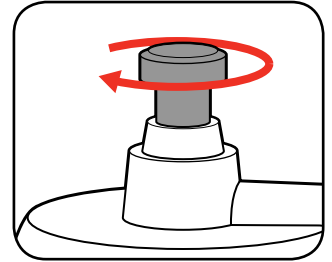

- 2 Slightly loosen the air regulator dial, then test setting on a scrap piece of material.

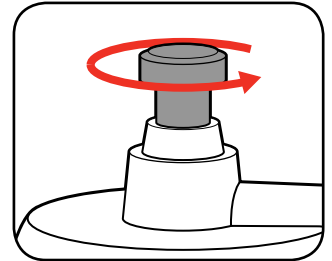

- 3 Repeat step 2 until desired fluid output is reached.

### Airbrushing Technique

Airbrushing has a range of techniques to obtain different effects. Below are some basic effects that can be obtained through the motion of the airbrush and distance from the work piece.

#### Distance from the Workpiece:

Positioning the airbrush close to the workpiece, will produce a small dense pattern.

Positioning the airbrush far from the workpiece, will produce a wide faint pattern.

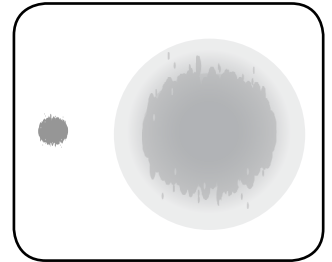

#### Angle to the Workpiece:

Angling the airbrush to the workpiece will produce an elongated pattern that will grow wider.

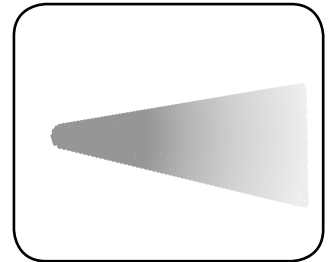

**IT IS CRUCIAL TO CLEAN THE AIRBRUSH AFTER EACH USE. Please refer to the cleaning procedure.**

# CLEANING PROCEDURE

**NOTE:** After each use it is essential that the airbrush is cleaned thoroughly. Failure to do so will likely cause blockages which will prevent the tool from working.  
**FAILURE TO CLEAN THE TOOL WILL VOID THE WARRANTY.**

- 1 Empty the paint pot of remaining material.

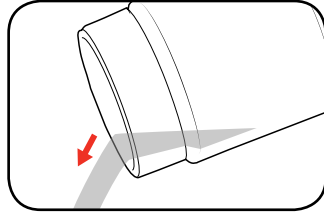

- 2 Fill paint pot with appropriate cleaning solution.

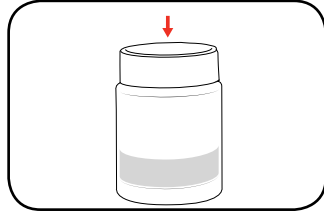

- 3 Connect the airbrush to the air supply then spray solution onto a scrap piece of cardboard.

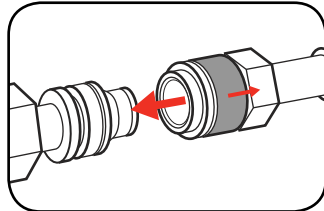

- 4 Repeat steps 2-3 until the cleaning solution runs clear from gun.

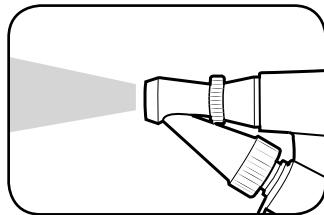

- 5 Disconnect the airsupply. Remove the paint pot and rinse.

# TROUBLE SHOOTING

Problem	Cause	Remedy
Little or no material flow	Nozzle clogged Fluid regulator too limited Paint pot vent hole blocked Paint too thick	Clean Unscrew paint regulator Clean Thin material
Spray pattern is heavy in the middle	Nozzle clogged Not enough atomizing pressure	Clean Unscrew the air regulator
Spray pattern is too wide and misty	Too much atomizing pressure	Screw in the air regulator or decrease air pressure at the supply
Spray jet pulsates	Material in paint pot running out Nozzle clogged Material too thick	Refill Clean or replace Thin material
Pattern runs or sags	Applying too much material	Decrease fluid regulator or increase movement speed
Too much overspray	Gun too far from spray object Too much material applied	Reduce distance Decrease fluid regulator
Pattern is very light and spotty	Moving the airbrush too fast	Decrease fluid regulator or decrease movement speed

# DESCRIPTION OF SYMBOLS

	Warning		Read instruction manual
	Wear ear protection		Wear eye protection and breathing mask
ml/min	Millilitres per minute	cfm	Cubic feet per minute

# SPARE PARTS

Spare parts can be ordered from the Special Orders Desk at your local Bunnings Warehouse.

For further information, or any parts not listed here, visit [www.ozito.com.au](http://www.ozito.com.au) or contact Ozito Customer Service:

Australia 1800 069 486

New Zealand 0508 069 486

E-mail: [enquires@ozito.com.au](mailto:enquires@ozito.com.au)

# MAINTENANCE

- Keep the the airbrush clean at all times. If possible, prevent foreign matter from entering the internals.
- If the body of the airbrush requires cleaning, never immerse any part of the airbrush into a liquid.

*Note: Ozito Industries will not be responsible for any damage or injuries caused by the repair of the airbrush by an unauthorised person or by mishandling of the airbrush.*

# CARING FOR THE ENVIRONMENT



Power tools that are no longer usable should not be disposed of with household waste but in an environmentally friendly way. Please recycle where facilities exist. Check with your local council authority for recycling advice.



Recycling packaging reduces the need for landfill and raw materials. Reuse of recycled material decreases pollution in the environment. Please recycle packaging where facilities exist. Check with your local council authority for recycling advice.



# GENERAL AIR TOOL SAFETY WARNINGS



**WARNING!** Read all safety warnings and all instructions. Failure to follow the warnings and instructions may result in electric shock, fire and/or serious injury.

Save all warnings and instructions for future reference. The term “power tool” in the warnings refers to your mains-operated (corded) power tool or battery-operated (cordless) power tool.

## 1. Work area safety

- a. **Keep work area clean and well lit.** Cluttered or dark areas invite accidents.
- b. **Do not operate power tools in explosive atmospheres, such as in the presence of flammable liquids, gases or dust.** Power tools create sparks which may ignite the dust or fumes.
- c. **Keep children and bystanders away while operating a power tool.** Distractions can cause you to lose control.
- d. **Dress properly. Do not wear loose clothing or jewellery. Keep your hair, clothing and gloves away from moving parts.** Loose clothes, jewellery or long hair can be caught in moving parts.
- e. Check the maximum pressure rating of any tools or accessories that you intend using with the compressor. The output pressure of the air from the compressor must be regulated so that it never exceeds the rated pressure of the tool or accessory.
- f. Always wear safety goggles or glasses when using the air compressor. Never point the nozzle of an accessory towards any part of your body or towards another person.
- g. **Drain the moisture from the tank daily.** It will help prevent corrosion.
- h. Use safety equipment including safety goggles or shield, ear protection, breathing or respirator mask and protective clothing.
- i. The tool must be used only for its prescribed purpose. Any use other than those mentioned in this Manual will be considered a case of misuse. The user and not the manufacturer shall be liable for any damage or injury resulting from such cases of misuse.



**WARNING!** In the event that an air line is cut or broken, the air supply must be turned off at the compressor. A broken air line which is not supported is extremely dangerous and can whip around very quickly, both with the capability of striking people, and blowing foreign particles into the air.

- Do not attempt to catch the air line but immediately keep bystanders well clear and turn off the air supply to the hose, turn off the compressor at the On / Off button, and then remove the hose from the compressor.
- This appliance is not intended for use by persons (including children) with reduced physical, sensory or mental capabilities, or lack of experience and knowledge, unless they have been given the supervision or instruction concerning use of the appliance by a person responsible for their safety.
- Children should be supervised to ensure that they do not play with the appliance.



# AIRBRUSH SAFETY WARNINGS



## WARNING!

**This appliance is not intended for use** by persons (including children) with reduced physical, sensory or mental capabilities, or lack of experience and knowledge, unless they have been given supervision or instruction concerning use of the appliance by a person responsible for their safety.

### Using an Extension Hose

Always use an approved extension hose suitable for the air input of this tool. Before use, inspect the hose for signs of damage, wear and ageing. Replace the extension hose if damaged or defective.

When using a hose on a reel, always unwind the lead completely.

It is recommended that the hose is a maximum of 25m in length.

**NEVER under any circumstances aim the nozzle at another person or animal.**

- In the event of an injury occurring, seek medical advice immediately.
- The airbrush must not be used for spraying flammable paints and solvents with a flash point of less than 21°C.
- Always ensure there is adequate ventilation when spraying.
- Eye protection is recommended to keep hazardous vapours and liquids out of eyes.
- Always wear a face mask when spraying.
- Always read the paint manufacturers thinning instructions before using.
- Always keep the spray nozzle in place during use. Never allow the spray to come in direct contact with the skin.
- Never immerse the airbrush in liquid.
- The airbrush must not be cleaned by using flammable liquids with a flash point of less than 21°C.

**NEVER spray near a naked flame, including an appliance pilot light.**

**NEVER smoke whilst spraying.**

**NEVER allow children to operate or play with the airbrush.**

- Before cleaning, always disconnect the appliance from the air supply.
- Always disconnect from air supply when refilling the paint pot.
- After every use ensure you clean your airbrush thoroughly.

**NEVER use the airbrush outside when it is raining.**

# WARRANTY

IN ORDER TO MAKE A CLAIM UNDER THIS WARRANTY YOU MUST RETURN THE PRODUCT TO YOUR NEAREST BUNNINGS WAREHOUSE WITH YOUR BUNNINGS REGISTER RECEIPT. PRIOR TO RETURNING YOUR PRODUCT FOR WARRANTY PLEASE TELEPHONE OUR CUSTOMER SERVICE HELPLINE:

**Australia 1800 069 486**

**New Zealand 0508 069 486**

TO ENSURE A SPEEDY RESPONSE PLEASE HAVE THE MODEL NUMBER AND DATE OF PURCHASE AVAILABLE. A CUSTOMER SERVICE REPRESENTATIVE WILL TAKE YOUR CALL AND ANSWER ANY QUESTIONS YOU MAY HAVE RELATING TO THE WARRANTY POLICY OR PROCEDURE.

The benefits provided under this warranty are in addition to other rights and remedies which are available to you at law.

Our goods come with guarantees that cannot be excluded at law. You are entitled to a replacement or refund for a major failure and for compensation for any other reasonably foreseeable loss or damage. You are also entitled to have the goods repaired or replaced if the goods fail to be of acceptable quality and the failure does not amount to a major failure.

Generally you will be responsible for all costs associated with a claim under this warranty, however, where you have suffered any additional direct loss as a result of a defective product you may be able to claim such expenses by contacting our customer service helpline above.

## 3 YEAR REPLACEMENT WARRANTY

Your product is guaranteed for a period of **36 months from the original date of purchase** and is intended for DIY (Do It Yourself) use only. If a product is defective it will be replaced in accordance with the terms of this warranty. Warranty excludes consumable parts.

## WARNING

**The following actions will result in the warranty being void.**

- If the tool has been operated on a supply voltage other than that specified on the tool.
- If the tool shows signs of damage or defects caused by or resulting from abuse, accidents or alterations.
- Failure to perform maintenance as set out within the instruction manual.
- If the tool is disassembled or tampered with in any way.
- Professional, industrial or high frequency use.